

STATE OF UTAH



OFFICE OF THE LIEUTENANT GOVERNOR
CERTIFICATE OF ANNEXATION

I, GREG BELL, LIEUTENANT GOVERNOR OF THE STATE OF UTAH,
HEREBY CERTIFY THAT there has been filed in my office a notice of annexation from
LEHI CITY, dated April 27th, 2010, complying with Section 10-2-425, Utah Code
Annotated, 1953, as amended.

NOW, THEREFORE, notice is hereby given to all whom it may concern that the
attached is a true and correct copy of the notice of annexation, referred to above, on file
with the Office of the Lieutenant Governor pertaining to LEHI CITY, located in Utah
County, State of Utah.

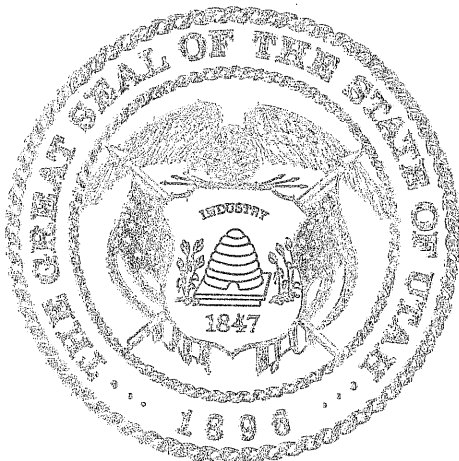

IN TESTIMONY WHEREOF, I have
hereunto set my hand, and affixed the Great
Seal of the State of Utah this 29th day of
June, 2010 at Salt Lake City, Utah.

A handwritten signature in black ink, appearing to read "Greg Bell".

GREG BELL
Lieutenant Governor

RESOLUTION NO. 84-27-10.F

RESOLUTION OF INTENT OF LEHI CITY COUNCIL TO
ANNEX REAL PROPERTY
(GUNNISON VALLEY ANNEXATION)

WHEREAS, the Lehi City Council has determined that certain parcels of real property described on Attachment "A" constitute a portion of an unincorporated island which is contiguous to Lehi City Corporation and should be annexed to Lehi City Corporation; and

WHEREAS, the area to be annexed consists of one or more unincorporated islands or unincorporated peninsulas contiguous to the municipality, each of which has fewer than 800 residents; and

WHEREAS, Lehi City Corporation has provided one or more municipal-type services to the area for at least one year; and

WHEREAS, the Lehi City Council does hereby determine that not annexing the entire unincorporated island or peninsula to which the subject parcels belong is in the best interest of Lehi City Corporation;

NOW THEREFORE, BE IT RESOLVED AS FOLLOWS:

1. The Lehi City Council does hereby determine that not annexing the entire unincorporated island or peninsula to which the subject parcels belong is in the best interest of Lehi City Corporation at this time.

2. Pursuant to the provision of Section 10-2-418 of the Utah Code, the Lehi City Council hereby intends to annex the parcel of real property owned by Gunnison Valley Bank located at approximately 2264 North 1450 East, Lehi, Utah, consisting of about 0.03 acres and further described by Attachment "A".

3. Staff is directed to publish notice of this proposed annexation in a newspaper of general circulation within Lehi City, once a week for three successive weeks. Said notice shall comply with the requirements of Section 10-2-418(2)(b) of the Utah Code.

4. This Resolution shall be effective upon the date of its adoption.

PASSED AND APPROVED by the City Council of Lehi City, Utah this

27th day of April, 2010.



BERT WILSON, Mayor

ATTEST:

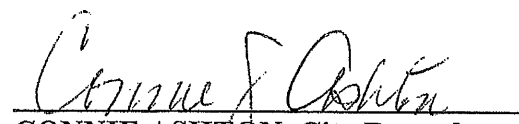

CONNIE ASHTON, City Recorder

P.H
May 25th

NOTICE OF INTENT TO ANNEX REAL PROPERTY

Notice is hereby given that Lehi City Corporation has adopted a resolution indicating its intent to annex real property owned by Scott Carlson at 2264 North 1450 East, Lehi, Utah consisting of about 0.04 acre of property and further described as follows:

SURVEYOR'S CERTIFICATE

I HEREBY CERTIFY THAT THIS IS A TRUE AND ACCURATE MAP OF THE TRACT OF LAND TO BE ANNEXED TO LEHI CITY, UTAH COUNTY, UTAH

BOUNDARY DESCRIPTION

1 PARCEL OF LAND LYING WITHIN THE NORTHWEST 1/4 OF SECTION 3, TOWNSHIP 5 SOUTH, RANGE 1 EAST, S18M, UTAH COUNTY, UTAH MORE PARTICULARLY DESCRIBED AS:

COMMENCING AT THE NORTH QUARTER CORNER OF SAID SECTION 3, THENCE S89°54'28"W, 363.31 FEET AND SOUTH 1636.06 FEET TO THE POINT OF BEGINNING THENCE AS FOLLOWS:

COURSE	DISTANCE	REMARKS
S65°51'00"E.	78.89'	ALONG THE LAIRD EAST ANNEXATION (LEHI CITY); THENCE
S00°53'52"E.	0.16'	ALONG THE HIGHLAND NO.2 ANNEXATION (HIGHLAND CITY); THENCE
N78°13'28"W.	84.83'	THENCE
N86°12'05"W.	76.49'	THENCE
NORTH	10.86'	TO THE LAIRD EAST ANNEXATION (LEHI CITY); THENCE
S89°28'43"E.	87.39'	ALONG THE LAIRD EAST ANNEXATION (LEHI CITY); TO BEGINNING.
CONTAINS 1,810 SQ. FT.		

A public hearing has been scheduled before the Lehi City Council on 8th day of June, 2010, at 7:00 p.m. for the purpose of receiving public comment.

The Lehi City Council will annex the above described parcels unless, at or before the public hearing, written protests to the annexation are filed by the owners of real property located within the area proposed for annexation covering a majority of the total private land area within the entire area proposed for annexation and also is equal to at least 1/2 the value of all private real property within the entire area proposed for annexation.

SURVEYOR'S CERTIFICATE

I, **DAVID R. HARRIS**, being duly sworn, depose and say that I am a duly licensed and active member of the Utah State Board of Professional Engineers and Surveyors, and that I am duly qualified to perform the duties of a surveyor.

BOUNDARY DESCRIPTION

THE BOUNDARY OF THE LAND DESCRIBED IN THIS CERTIFICATE IS AS SHOWN ON THE ATTACHED MAP, AND THE SAME IS CORRECTLY LOCATED AND DESCRIBED THEREON.

THE BOUNDARY OF THE LAND DESCRIBED IN THIS CERTIFICATE IS AS SHOWN ON THE ATTACHED MAP, AND THE SAME IS CORRECTLY LOCATED AND DESCRIBED THEREON.



ACCEPTANCE BY LEGISLATIVE BODY

THIS IS TO CERTIFY THAT THE ABOVE DESCRIBED LAND IS BEING ANNEXED TO THE CITY OF GUNNISON, UTAH, AND THAT THE SAME IS CORRECTLY LOCATED AND DESCRIBED THEREON.

THE CITY OF GUNNISON, UTAH, HAS ADOPTED THIS ANNEXATION PLAN BY RESOLUTION NO. 11540033, PASSED ON MAY 11, 2010.



ANNEXATION PLAT

GUNNISON VALLEY ANNEXATION

UTAH COUNTY, UTAH
SCALE: 1" = 10' FEET

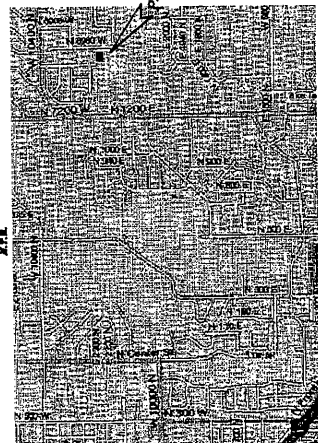

PROJECT LOCATION

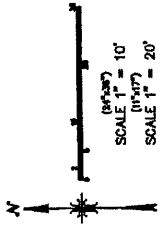

1450 EAST (EXISTING CITY ROAD)

LEGEND

- SECTION CORNER
- ENCLAVED POINT, NOT SET
- LOT CITY BOUNDARY
- HIGHLAND CITY BOUNDARY

HIGHLAND NO. 2 ANNEXATION

WEST DAVIS & COMPANY
PARCEL #11540033

MERRILL HARRIS & SONS
PARCEL #11540034

SECTION CORNER
NORTH 1/4 CORNER
S. 1/4 T. 10 N., R. 1 E., S. 10 W.

(EXISTING) GUNNISON VALLEY BANK
PARCEL #11540035
(LOT 8 HARRIS & SONS PLAT '97)

LAIRD EAST ANNEXATION

GUNNISON VALLEY BANK
PARCEL #11540036
1450 E. FT. GUNNISON
ZONE # R-1-18

1450 E. FT. GUNNISON
ZONE # R-1-18

JAMES LLC
PARCEL #11540038

JAMES LLC
PARCEL #11540038