

STATE OF UTAH



OFFICE OF THE LIEUTENANT GOVERNOR
CERTIFICATE OF ANNEXATION

I, GREG BELL, LIEUTENANT GOVERNOR OF THE STATE OF UTAH,
HEREBY CERTIFY THAT there has been filed in my office a notice of annexation from
SANDY CITY, dated January 3rd, 2012, complying with Section 10-2-425, Utah Code
Annotated, 1953, as amended.

NOW, THEREFORE, notice is hereby given to all whom it may concern that the
attached is a true and correct copy of the notice of annexation, referred to above, on file
with the Office of the Lieutenant Governor pertaining to SANDY CITY, located in Salt
Lake County, State of Utah.



IN TESTIMONY WHEREOF, I have
hereunto set my hand, and affixed the Great
Seal of the State of Utah this 19th day of
March, 2012 at Salt Lake City, Utah.

A handwritten signature in black ink that reads "Greg Bell".

GREG BELL
Lieutenant Governor



March 8, 2012

Greg Bell, Lieutenant Governor
Lieutenant Governor's Office
Utah State Capital Complex, Suite 200
350 North State Street
Salt Lake City, Utah 84114

Re: McCann Annexation

Dear Lieutenant Governor Bell:

To comply with Section 10-2-425 of the Utah Code, the legislative body of Sandy City is filing the following documents with the lieutenant governor for the McCann annexation:

1. a notice of an impending boundary action, as defined in Section 67-1a-6.5, that meets the requirements of Subsection 67-1a-6.5(3); and
2. a copy of an approved final local entity plat, as defined in Section 67-1a-6.5.

As per instructions from your office, the local entity plats have been reduced in size to a standard letter size and we have also attached copies of the ordinances annexing the McCann area.

We understand that within ten days, as per Subsection 67-1a-6.5(2), you will issue the annexation certificates if you determine the notices of the impending boundary action meet the requirements of Subsection 67-1a-6.5(3), and the notices are accompanied by approved local entity plats.

If you are unable to issue the annexation certificate, please notify us as soon as possible.

Thank you very much.

Sincerely

Patrick R. Casaday
Sandy City Attorney's Office

Enclosures

1. **Notice of Impending Boundary Action - McCann Annexation**
2. **Approved Final Local Entity Plat - McCann Annexation**
3. **McCann Annexation Ordinance**

Notice of Impending Boundary Action with Approved Final Local Entity Plan

March 5, 2012

Greg Bell, Lieutenant Governor
Lieutenant Governor's Office
Utah State Capital Complex, Suite 200
350 North State Street
Salt Lake City, Utah 84114

Dear Lieutenant Governor Bell:

Annexations in Sandy City are approved by the City Council - the City's legislative body. On or about February 28, 2012, the City Council adopted an ordinance approving the following annexation:

McCann Annexation to Sandy City

As chair of the Sandy City Council during this time, and on behalf of Sandy City, I hereby notify you of this impending boundary action which is more fully described in the Approved Final Local Entity Plan which accompanies this notice. I further certify that all requirements applicable to this annexation have been met.

Accordingly, on behalf of the Sandy City Council, I request that you issue a Certificate of Annexation for this boundary action as described in Section 67-1a-6.5 of the Utah Code. Section 10-2-425(4)(b) of the Utah Code provides that the effective date of the annexation is the date on which you issue the Certificate of Annexation

Respectfully submitted,



Chris McCandless
Chair, Sandy City Council

MCCANN ANNEXATION
ORDINANCE # 12-09

AN ORDINANCE ANNEXING TERRITORY LOCATED AT APPROXIMATELY 2938 EAST 9800 SOUTH, SALT LAKE COUNTY, COMPRISING APPROXIMATELY 0.267 ACRES, INTO SANDY CITY; ESTABLISHING ZONING FOR THE ANNEXED PROPERTY; ALSO PROVIDING A SEVERANCE AND EFFECTIVE DATE FOR THE ANNEXATION

The Sandy City Council finds:

1. Section 10-2-418, Utah Code Annotated, authorizes the City to annex contiguous areas within unincorporated county islands without a petition if it satisfies certain statutory requirements.
2. The City has complied with all statutory requirements, in that : (1) the area proposed to be annexed, located at approximately 2938 East 9800 South in Salt Lake County ("Area"), is a contiguous area and is contiguous to the City; (2) the Area consists of a portion of an unincorporated Salt Lake County island or peninsula within the City; (3) the island or peninsula, a portion of which is being annexed, has fewer than 800 residents; (4) the majority of the island or peninsula consists of residential or commercial development; (5) the Area requires the delivery of municipal-type services; and (6) the City has provided one or more municipal-type services to the island or peninsula and to the Area for more than one year.
3. On January 3, 2012, the City adopted Resolution 12-1C, attached hereto as Exhibit "A", describing the Area and indicating the City's intent to annex the Area. The City determined that not annexing the entire island or peninsula was in its best interest.
4. The City published Notice to hold a public hearing on the proposed annexation of the Area. The Notice was published at least once a week for three successive weeks in a newspaper of general circulation within the City and within the Area, and the City sent written notice to the board of each special district whose boundaries contain some or all of the Area, and to the Salt Lake County legislative body. The Notice, a copy of which is attached hereto as Exhibit "B", complied with all statutory requirements.
5. On February 14, 2012, the City Council held a public hearing on the proposed annexation. Prior to the public hearing, the owners of at least 75% of the total private land area representing at least 75% of the value of the private real property within the Area consented in writing to the annexation. Such consent is attached hereto as Exhibit "C". As such, the City may adopt an ordinance annexing the Area without allowing or considering protests and the Area is conclusively presumed to be annexed, as per Section 10-2-418(3)(b), Utah Code Annotated. Only those property owners living within the area proposed for annexation have standing to protest the proposed annexation, as per Section

10-2-418 (2)(b)(iv), Utah Code Annotated.

6. The annexation of the Area is completed and takes effect on the date of the lieutenant governor's issuance of a certificate of annexation as per Section 10-2-425(4), Utah Code Annotated.

NOW, THEREFORE, BE IT ORDAINED by the City Council that it does hereby :

1. Adopt an ordinance annexing the Area as shown on the plat filed in the office of the Sandy City Recorder.
2. Determine that not annexing the entire island or peninsula is in the City's best interest.
3. Zone the Area to an R-120 zone (single family residential on a minimum of 20,000 square foot lots).
4. Confirm that, pursuant to Section 10-2-425(4), Utah Code Annotated, this annexation is completed and takes effect upon the date of the lieutenant governor's issuance of a certification of annexation.
5. Declare that all parts of this ordinance are severable and that if the annexation of the Area shall, for any reason, be held to be invalid or unenforceable, this shall not affect the validity of any associated or subsequent annexation.
6. Affirm that this ordinance shall become effective upon publication as provided by law.

PASSED AND APPROVED by vote of the Sandy City Council this 21 day of February 2012.

Chair, Sandy City Council

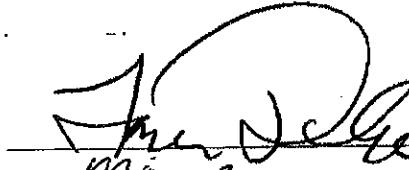
Mayor

City Recorder

PRESENTED to the Mayor of Sandy City this 23rd day of February, 2012.

APPROVED by the Mayor of Sandy City this 23rd day of February, 2012.

Published February 28, 2012



MCCANN ANNEXATION

RESOLUTION # 12-1C

A RESOLUTION INDICATING INTENT TO ANNEX AN UNINCORPORATED AREA, SETTING A HEARING TO CONSIDER SUCH AN ANNEXATION, AND DIRECTING PUBLICATION OF HEARING NOTICE.

The City Council of Sandy City, State of Utah, finds and determines as follows:

1. Sandy City ("City") desires to annex a certain contiguous unincorporated area, totaling approximately 0.267 acres, located at approximately 2938 East 9800 South in Salt Lake County, Utah, and more specifically described in the legal description attached hereto as Appendix "A". The City is authorized to annex the area without a petition pursuant to 10-2-418 Utah Code Annotated.

2. The area proposed to be annexed consists of a portion of one or more unincorporated islands within or unincorporated peninsulas contiguous to the City, each of which has fewer than 800 residents.

3. The City has provided one or more municipal-type services to the area for at least one year.

4. The annexation of that portion of an island or peninsula, leaving unincorporated the remainder of that island or peninsula, is in the City's best interests.

NOW, THEREFORE, BE IT RESOLVED by the City Council of Sandy City, Utah that it does hereby:

1. Indicate the City Council's intent to annex the area described in Appendix "A."
2. Determine that not annexing the entire unincorporated island or unincorporated peninsula is in the City's best interest;
3. Set a public hearing for February 14, 2012, at 7:05 p.m. to consider the annexation.
4. Direct the City Recorder to publish and send notice of such hearing in accordance with Utah Code Ann. § 10-2-418(2)(a).

ADOPTED by the Sandy City Council this 3 day of January, 2012.

Sandy City Council Chair

ATTEST:

Molly Spurr
City Recorder

RECORDED this 4th day of January, 2012.



McCANN ANNEXATION DESCRIPTION
December 1, 2011

Beginning at the southwest corner of Lot 8, GLACIER MESA SUBDIVISION, AMENDED PLAT - LOTS 4-9, according to the official plat thereof, recorded December 14, 1977 as Entry No. 3038121 in Book 77-12 of plats at Page 356 in the office of the Salt Lake County Recorder, said point being a southwesterly corner of the current Sandy City boundary established by a previous annexation to Sandy City recorded June 21, 1976 as Entry No. 2826908 in Book 76-6 of plats at Page 133 in the office of the Salt Lake County Recorder, said point lies, according to said plats, South 89°55'14" West along the quarter section line 1122.01 feet and South 0°29'01" East 272.25 feet from the Salt Lake County monument representing the Center Quarter Corner of Section 11; Township 3 South, Range 1 East, Salt Lake Base and Meridian (Basis of bearing for this description is South 89°35'15" East 2664.29 feet along the quarter section line defined by Salt Lake County monuments representing the Center Quarter Corner and the East Quarter Corner of said Section 11 as shown on said recorded plat of GLACIER MESA SUBDIVISION. AMENDED - LOTS 4-9.); thence from said point of beginning along the current Sandy City boundary and the southerly line of said Lot 8, North 89°55'14" East 107.00 feet to the southeast corner of said Lot 8; thence North 89°55'14" East along the current Sandy City boundary and the southerly line of Lot 7 of said subdivision, 3.41 feet; thence along the boundary of that certain parcel of land identified as parcel no. 28-11-327-061-4002 by the Salt Lake County Assessor the following four courses: (1) South 103.52 feet; (2) South 89°55'14" West 112.20 feet, more or less, to the current Sandy City boundary established by a previous annexation to Sandy City recorded April 1, 1976 as Entry No. 2800062 in Book 76-4 of plats at Page 66 in the office of the Salt Lake County Recorder; (3) North along said current Sandy City boundary, 103.52 feet; (4) North 89°55'14" East 1.79 feet to the point of beginning. The above described parcel of land contains approximately 11,615 square feet in area or 0.267 acre.

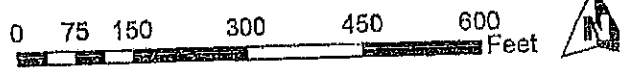
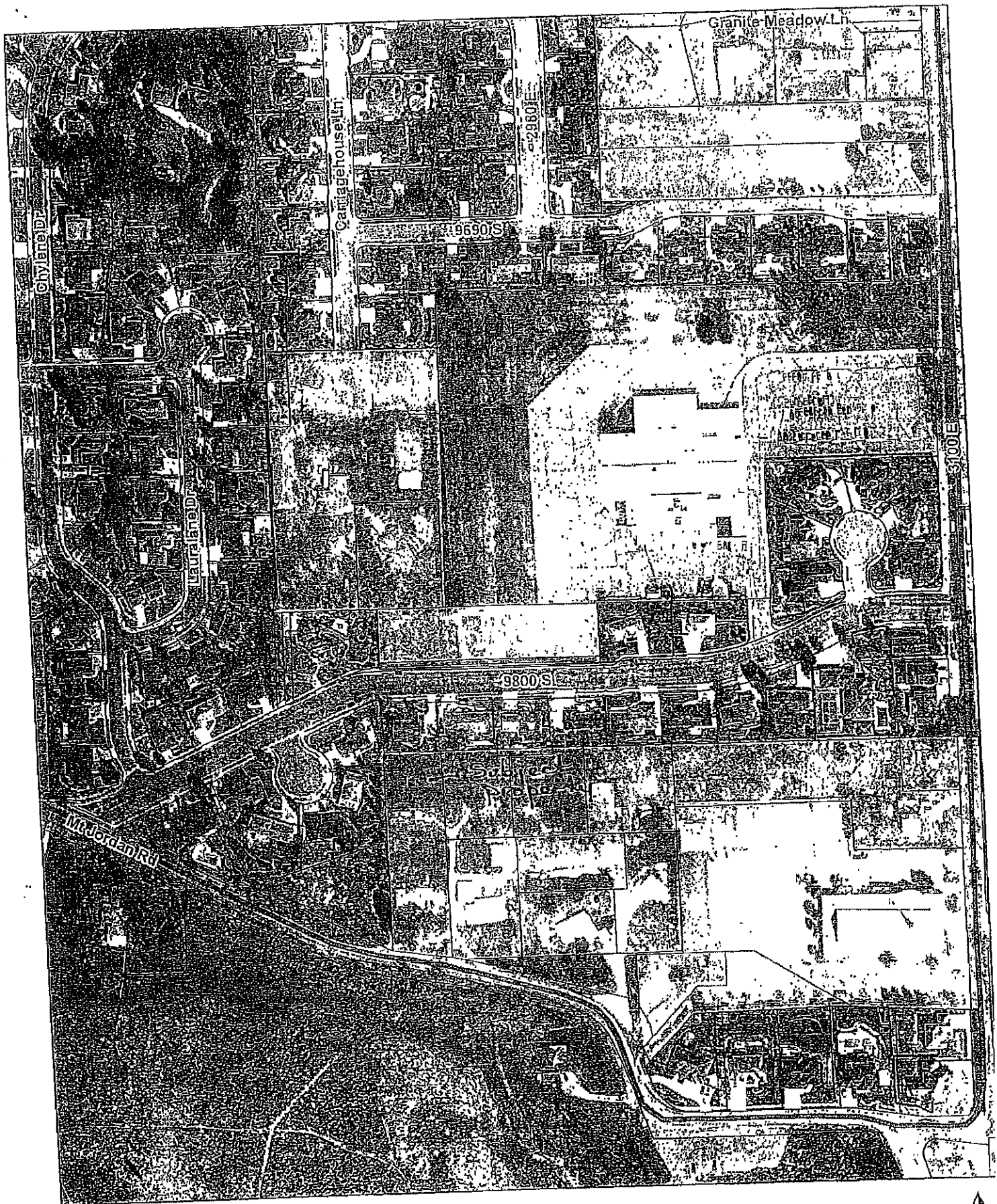

770 S. 5600 W.
 P.O. BOX 704005
 WEST VALLEY CITY, UTAH 84170
 'ED.TAX I.D.# 87-0217663

The Salt Lake Tribune
 www.sltrib.com

MEDIA One
 OF UTAH
 A NEWSPAPER AGENCY COMPANY
 www.mediagroup.com

Exhibit "B"
 Deseret News
 www.deseretnews.com

PROOF OF PUBLICATION

CUSTOMER'S COPY

CUSTOMER NAME AND ADDRESS	ACCOUNT NUMBER	DATE
SANDY CITY RECORDERS OFFICE, MOLLY SPIRA 10000 CENTENNIAL PRKWY SANDY, UT 84070	9001361894	2/1/2012

ACCOUNT NAME	
SANDY CITY RECORDERS OFFICE,	
TELEPHONE	AD ORDER / INVOICE NUMBER
8015687135	0000757508 / 100757508-01172012
SCHEDULE	
Start 01/17/2012	End 01/31/2012
CUST. REF. NO.	
Legal Notice	
CAPTION	
Sandy City Public Hearing - Intent to Annex McCann Annexation Notice is hereby given	
SIZE	
45 Lines	2.00 COLUMN
LINES	
9	
MISC. CHARGES	
TOTAL DOLLARS	
342.50	

Sandy City Public Hearing - Intent to Annex McCann Annexation

Notice is hereby given that the Sandy City Council has adopted a resolution indicating its intent to annex an unincorporated area located at approximately 2938 East 9800 South in the Municipality of Sandy City. On Tuesday, February 1, 2012 at 7:05 p.m., the Sandy City Council will hold a public hearing on this proposed annexation in the Council Chamber, Sandy City Hall, 10000 Centennial Parkway, Sandy, Utah. Legal Description: Beginning at the southeast corner of Lot 1 GLACIER MEADOWS SUBDIVISION, AMENDED PLAT - LOTS 4-9; & according to the official plat, thence, said point lies South 89° 55' 14" West along the quarter section line 1122.01 feet and South 0° 29' 01" East 222.25 feet from the Center Quarter Corner of Section 11, Township 3 South, Range 1 East Salt Lake Base and Meridian, thence North 89° 55' 14" East 3.41 feet, thence South 103.52 feet, thence North 89° 55' 14" West 1.79 feet to the southwest corner of said Lot B, thence North 89° 55' 14" East 107.00 feet to the point of beginning. Contains 1.618 square feet, 0.267 acres.

The City Council will annex the area unless written protests the annexation are presented at the public hearing or a filed by 5:00 p.m. on the day of such hearing. With the Sandy City Recorder, Sandy City Hall, 10000 Centennial Parkway, Sandy, Utah, by the owners of private property:

(A) is located within the area proposed for annexation;
 (B) covers a majority of the total private land area with the entire area proposed for annexation; and
 (C) is equal in value to at least 25% the value of all private real property within the entire area proposed for annexation.

The area under consideration for annexation comprises a parcel of approximately 0.267 acres. It is being proposed to annex property into the City with the R-1-10 Zone (single family residential) on a minimum 10,000 square foot lot. The Council may consider approving a density that is either higher or lower than the proposed R-1-10 Zone. Any questions may have regarding this annexation petition may be directed to the City Planner in the Community Development Department at 707 Jordan Avenue, Sandy, Utah, 84070.

AFFIDAVIT OF PUBLICATION

AS NEWSPAPER AGENCY COMPANY, LLC dba MEDIAONE OF UTAH LEGAL BOOKER, I CERTIFY THAT THE ATTACHED ADVERTISEMENT OF Sandy City Public Hearing - Intent to Annex McCann Annexation Notice is hereby given that the Sandy City Council has adopted a resolution indicating its intent FOR SANDY CITY RECORDERS OFFICE, WAS PUBLISHED BY THE NEWSPAPER AGENCY COMPANY, LLC dba MEDIAONE OF UTAH, AGENT FOR THE SALT LAKE TRIBUNE AND DESERET NEWS, DAILY NEWSPAPERS PRINTED IN THE ENGLISH LANGUAGE WITH GENERAL CIRCULATION IN UTAH, AND PUBLISHED IN SALT LAKE CITY, SALT LAKE COUNTY IN THE STATE OF UTAH. NOTICE IS ALSO POSTED ON UTAHLEGALS.COM ON THE SAME DAY AS THE FIRST NEWSPAPER PUBLICATION DATE AND REMAINS ON UTAHLEGALS.COM INDEFINATELY.

PUBLISHED ON Start 01/17/2012 End 01/31/2012

SIGNATURE *[Signature]*

DATE 2/1/2012

VIRGINIA CRAFT
 Notary Public, State of Utah
 Commission # 681469
 My Commission Expires
 January 12, 2014

[Signature]

THIS IS NOT A STATEMENT BUT A "PROOF OF PUBLICATION"
 PLEASE PAY FROM BILLING STATEMENT

Exhibit "C"

Date: 11-10, 2011

RECEIVED
NOV 10 2011
SANDY CITY
COMMUNITY DEVELOPMENT

Attn: James Sorensen
Sandy City Community Development
10000 Centennial Parkway
Sandy, Utah 84070

My name is Kimball H. McCann TR

I am (we are) the property owner(s) of property in the unincorporated area of Salt Lake County located at :

2938 E. 9500 So. Sandy, UT 84092

This property is part of an island or peninsula and is contiguous to Sandy City.

I (we) would like Sandy City to consider annexing this property.

I (we) can be reached at : 801-942-6173.

Thank you very much.

Kimball H. McCann TR
Signature

Signature