

STATE OF UTAH



OFFICE OF THE LIEUTENANT GOVERNOR

CERTIFICATE OF ANNEXATION

I, SPENCER J. COX, LIEUTENANT GOVERNOR OF THE STATE OF UTAH, HEREBY CERTIFY THAT there has been filed in my office a notice of annexation from NORTH VILLAGE SPECIAL SERVICE DISTRICT, dated March 25th, 2016, complying with Section 17D-1-403, Utah Code Annotated, 1953, as amended.

NOW, THEREFORE, notice is hereby given to all whom it may concern that the attached is a true and correct copy of the notice of annexation, referred to above, on file with the Office of the Lieutenant Governor pertaining to NORTH VILLAGE SPECIAL SERVICE DISTRICT, located in Wasatch County, State of Utah.

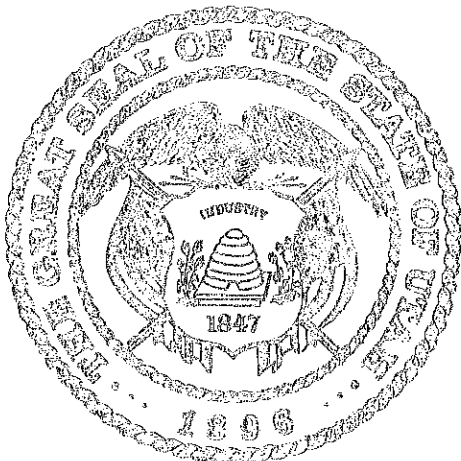

IN TESTIMONY WHEREOF, I have hereunto set my hand, and affixed the Great Seal of the State of Utah this 20th day of May, 2016 at Salt Lake City, Utah.

A handwritten signature in black ink, appearing to read "Spencer J. Cox".

SPENCER J. COX
Lieutenant Governor

Notice of Impending Boundary Action

Pursuant to Utah Code Annotated § 67-1a-6.5, the Wasatch County Council, acting as the Governing Body of the North Village Special Service District (the "Governing Body") hereby provides the Lieutenant Governor's Office with written notice of an impending boundary action that effects Wasatch County and the North Village Special Service District.

The Governing Body seeks a certificate of annexation as it relates to the North Village Special Service District. The Governing Body received a petition from the Zina McDonald Trust dated the 27th day of August, 1992 (the "McDonald Trust"), the sole owner of Wasatch County parcel 00-0020-8445, requesting that a portion of that property be annexed into the boundaries of the North Village Special Service District. Thereafter, on March 25, the Governing Body adopted Resolution 2016-05, to annex that property into the boundaries of the District.

The Governing Body hereby certifies that the attached constitutes a true and correct copy of the Resolution annexing territory into the boundaries of the North Village Special Service District as well as the approved final local entity plat. The Governing Body further certifies that all the requirements for the annexation of territory into the boundaries of the North Village Special Service District have been complied with pursuant to Utah Code Ann. § 17D-1-101.

Dated this 25 day of April, 2016

Kendall Cattermole
Chairperson of the Wasatch County Council

ATTEST

Sandy Hansen
Clerk-Deputy

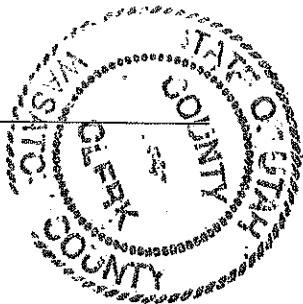

WASATCH COUNTY RESOLUTION 2016-05

A Resolution Annexing Certain Real Property to the
North Village Special Service District

Affects Tax Parcel No. 00-0020-8445

1. The North Village Special Service District received a petition for annexation pursuant to § 17D-1-402, Utah Code Ann., for the London Spring project.
2. The petition was signed by the owner of all the taxable real property within the area proposed to be annexed.
3. The North Village Special Service District approved of the annexation and forwarded the petition to the Wasatch County Council.
4. Pursuant to § 17D-1-401 and -402, the Wasatch County Council hereby approves the annexation of the area depicted and described in Exhibit A to the North Village Special Service District.
5. Pursuant to § 17D-1-403, the Wasatch County Council will file all necessary documentation with the Lieutenant Governor required for the annexation to be effective.
6. Upon issuance of a Certificate of Annexation by the Lieutenant Governor, the property as described in Exhibit A shall be deemed annexed to the North Village Special Service District.

Approved on March 25, 2016

Kendall Crittenden
Kendall Crittenden, Council Chair

Brent Titcomb
Brent Titcomb, Clerk/Auditor

Mike Petersen	<u>Y</u>
Danny Goode	<u>N</u>
Steve Farrell	<u>—</u>
Kendall Crittenden	<u>Y</u>
Greg McPhie	<u>Y</u>
Kipp Bangerter	<u>Y</u>
Mike Kohler	<u>Y</u>

EXHIBIT A

[Attach London Spring Annexation Plat]

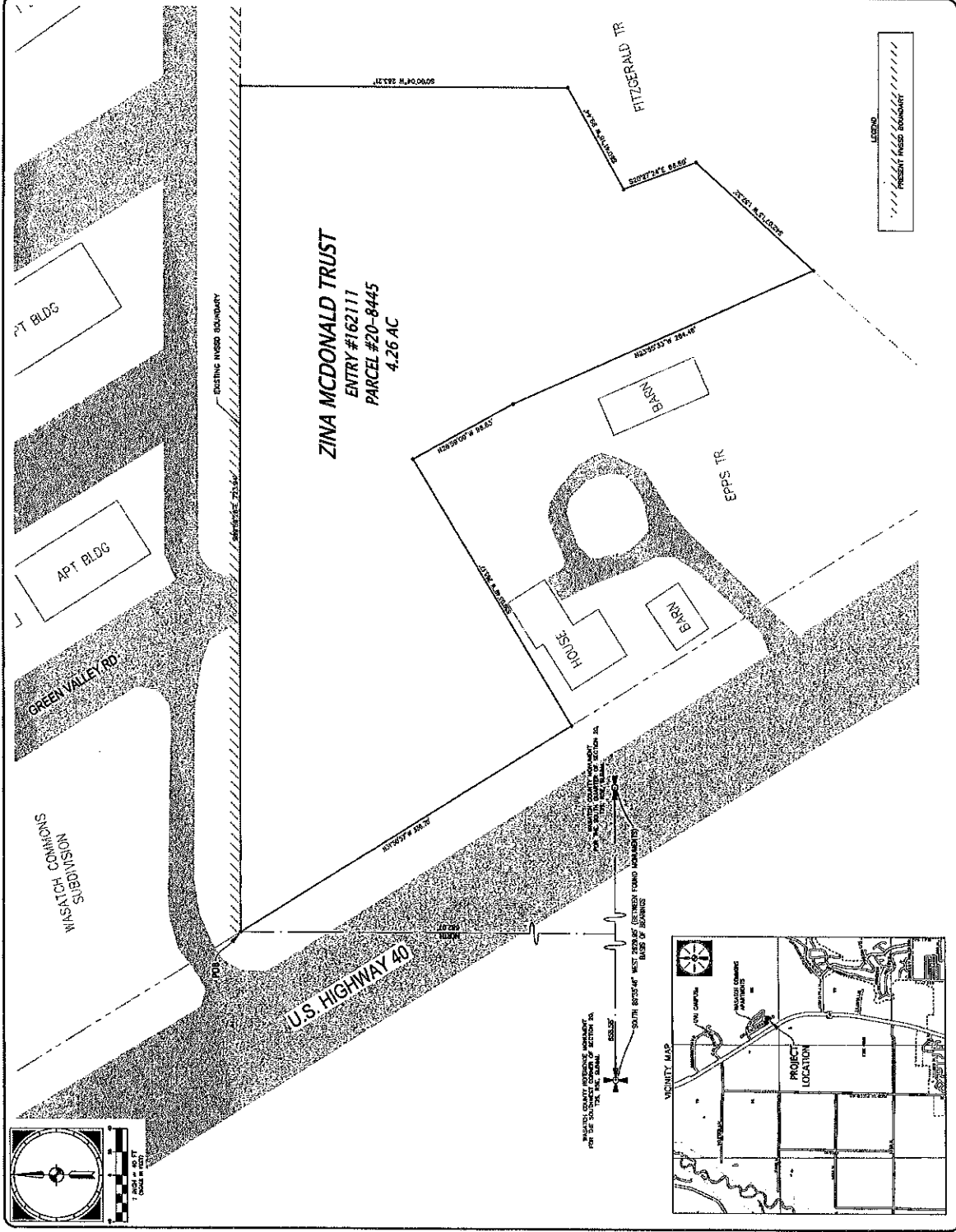

SURVEYOR'S CERTIFICATE

I, the undersigned, being duly sworn, do hereby certify that I am a duly Licensed Professional Surveyor in the State of Utah and that I am duly qualified to perform the duties of a Surveyor in this State.

I have read the above plat and the accompanying field notes and find that the same are correct and true to the best of my knowledge and belief, and that the same conform to the provisions of the laws of this State relating to the practice of the Surveying profession.

Witness my hand and the seal of my office at Salt Lake City, Utah, this 15th day of April, 2014.

[Signature]
 PROFESSIONAL LAND SURVEYOR
 STATE OF UTAH, LICENSE NO. 12345

BOUNDARY DESCRIPTION

THESE BEARINGS AND DISTANCES WERE OBTAINED BY MEASUREMENTS MADE BY ME OR UNDER MY CLOSE PERSONAL SUPERVISION AND ARE TRUE TO THE BEST OF MY KNOWLEDGE AND BELIEF.

THESE BEARINGS AND DISTANCES WERE OBTAINED BY MEASUREMENTS MADE BY ME OR UNDER MY CLOSE PERSONAL SUPERVISION AND ARE TRUE TO THE BEST OF MY KNOWLEDGE AND BELIEF.

THESE BEARINGS AND DISTANCES WERE OBTAINED BY MEASUREMENTS MADE BY ME OR UNDER MY CLOSE PERSONAL SUPERVISION AND ARE TRUE TO THE BEST OF MY KNOWLEDGE AND BELIEF.

THESE BEARINGS AND DISTANCES WERE OBTAINED BY MEASUREMENTS MADE BY ME OR UNDER MY CLOSE PERSONAL SUPERVISION AND ARE TRUE TO THE BEST OF MY KNOWLEDGE AND BELIEF.

BASIS OF BEARINGS

THE BASIS OF BEARINGS FOR THE ABOVE MENTIONED UNRESOLVED BOUNDARY DISCREPANCY IS ESTABLISHED AS BEING THE TRUE MAGNETIC MERIDIAN AT THE TIME OF THE SURVEY.

THE BASIS OF BEARINGS FOR THE ABOVE MENTIONED UNRESOLVED BOUNDARY DISCREPANCY IS ESTABLISHED AS BEING THE TRUE MAGNETIC MERIDIAN AT THE TIME OF THE SURVEY.

THE BASIS OF BEARINGS FOR THE ABOVE MENTIONED UNRESOLVED BOUNDARY DISCREPANCY IS ESTABLISHED AS BEING THE TRUE MAGNETIC MERIDIAN AT THE TIME OF THE SURVEY.

ACCEPTANCE BY LEGISLATIVE BODY

THIS IS TO CERTIFY THAT THE ABOVE MENTIONED UNRESOLVED BOUNDARY DISCREPANCY HAS BEEN ACCEPTED BY THE LEGISLATIVE BODY OF THE STATE OF UTAH, AND THAT THE SAME SHALL BE CONSIDERED AS A PART OF THE PUBLIC RECORDS OF THE STATE OF UTAH.

APPROVED AND ACCEPTED:

[Signature]
 CLERK OF THE LEGISLATIVE BODY

DATE: 15 April 2014

COUNTY SURVEYOR: *[Signature]*
 COUNTY RECORDER: *[Signature]*

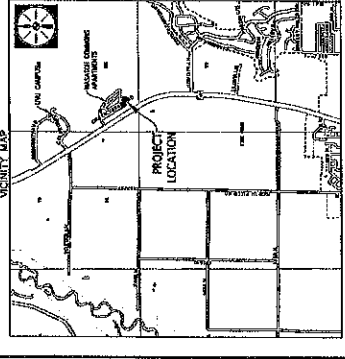
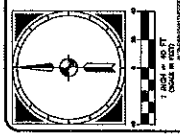

<p>PROJECT: CH-005</p> <p>SHEET: 1 OF 1</p>	<p>PREPARED FOR: ZINA MCDONALD TRUST</p> <p>PROJECT: LONDON SPRINGS ANNEXATION</p>	<p>LOCATED IN THE SOUTHWEST 1/4 SECTION 36, RANGE 06 EAST, T12N R10E WASHINGTON COUNTY, UTAH</p>	<p>DATE: 15 April 2014</p> <p>REVISION: 01</p> <p>BY: [Signature]</p> <p>SCALE: AS SHOWN</p>	<p>Summit Engineering Group Inc.</p> <p>1000 S. 1000 E. SUITE 100</p> <p>ST. GEORGE, UT 84770</p> <p>PHONE: 435.633.1111</p> <p>FAX: 435.633.1112</p> <p>WWW.SUMMITENGINEERING.COM</p>
---	--	--	--	--